

DATED 6th February 2020

**LONDON BOROUGH OF BARNET**

**SECTION 247  
TOWN AND COUNTRY PLANNING ACT 1990**

**THE STOPPING UP OF HIGHWAYS  
(LONDON BOROUGH OF BARNET)**

**BRENT CROSS CRICKLEWOOD REGENERATION PHASE 1A NORTH  
(CLAREMONT WAY EAST) STOPPING UP ORDER 2019**

## ORDER

### LONDON BOROUGH OF BARNET

#### SECTION 247 TOWN AND COUNTRY PLANNING ACT 1990

#### BRENT CROSS CRICKLEWOOD REGENERATION PHASE 1A NORTH (CLAREMONT WAY EAST) STOPPING UP ORDER 2019

MADE...6/2/20

**THIS ORDER** is made by the London Borough of Barnet ("the Council") acting in its capacity as a local highway authority and in exercise of its powers under Section 247 of the Town and Country Planning Act 1990 ("the Act") as amended by Section 270 and Schedule 22 of the Greater London Authority Act 1999 and of all other powers enabling it in that behalf.

#### BY THIS ORDER:

1. The Council authorises the stopping up of the highways described in the First Schedule to this Order and shown on the Deposited Plan, in order to enable the development described in the Second Schedule to this Order to be carried out in accordance with the following planning permissions granted under Part III of the Act by the Council:
  - i. Planning Permission dated 18 March 2019 with reference 18/6645/FUL;
  - ii. Planning Permission dated 11 April 2019 with reference 18/6409/RMA;
  - iii. Planning Permission dated 28 February 2018 with reference 17/6662/RMA; and
  - iv. Planning Permission dated 18 October 2019 with reference 19/2291/FUL.
2. Where immediately before the date of this Order there is any apparatus of statutory undertakers under, in, on, over, along or across any area of highway authorised to be stopped up under this Order then, subject to Section 261(4) of the Act, those statutory undertakers shall continue to have the same rights in respect of that apparatus after that area of highway is stopped up as they had immediately before the making of this Order.
3. References to the "**Deposited Plan**" shall mean the plan numbered 23624002-STR-HGN-100-DR-D-01002 Rev P4 deposited at the Main Reception, 2 Bristol Avenue, Colindale, London NW9 4EW.

#### DATE OF COMING INTO FORCE

4. This Order shall come into force on the date of confirmation of this order, and may be cited as the Brent Cross Cricklewood Regeneration Phase 1A North (Claremont Way East) Stopping Up Order 2019.

## THE FIRST SCHEDULE

### Description of highways to be stopped up

The highway areas/references and zones listed in the table below and shown hatched with thick black diagonal lines on Drawing No. 23624002-STR-HGN-100-DR-D-01002 Rev P4 attached to the Order. The dimensions quoted in the table are approximate averages and have been rounded to the nearest half metre. The drawing should be referred to for exact locations.

Name / Reference of Highway	Zone Reference / Address of Highway	Starting Grid reference	Ending Grid reference	Highway to be stopped up		
				Length (m)	Width (m)	Area (m <sup>2</sup> )
Claremont Way	Claremont Way, off Claremont Road, NW2	E = 523497.799 N = 187321.859	E = 523391.650 N = 187319.925	114m	17m	1756m <sup>2</sup>

## **THE SECOND SCHEDULE**

### **LOCATION**

Land at Claremont Way (East) to the north of Claremont Road, NW2

### **THE DEVELOPMENT**

Construction of highways infrastructure and associated public realm comprising High Street South (East Works), Claremont Park Road (Part 1), Claremont Avenue (south of High Street South (East Works) and Claremont Road Junction North, required in association with Phase 1 (South) of the consented redevelopment of the Brent Cross Cricklewood regeneration area (Ref: F/04687/13). Proposal includes including enabling works and other works incidental to the highways and public realm development (18/6645/FUL).

Provision of a new Neighbourhood Park (Claremont Park) comprising improvements and modifications to Claremont Way Open Space, changes to levels, hard and soft landscaping measures, the introduction of play equipment, park furniture, a pond, fencing, shared pedestrian and cycling routes and all associated enabling, incidental and temporary works (19/2291/FUL).

Details relating to layout, scale, appearance, access and landscaping for a residential-led mixed use development of Plot 11, comprising 352 residential units, flexible retail (Use Classes A1/A3), provision for a ground floor Neighbourhood Police Unit, basement and undercroft car parking, cycle parking, refuse storage and plant to be provided within two buildings with heights ranging from 8 to 13 storeys arranged around a private courtyard, together with an east-west publicly accessible route between the two buildings (18/6409/RMA).

Details relating to layout, scale, appearance, access and landscaping for Plot 12, comprising of 292 residential units, ancillary housing office, flexible retail, café, basement car parking and plant including heating plant, to be provided within two buildings with heights ranging from 6-13 storeys arranged around a public pocket park and private courtyard together with north-south and east-west tertiary streets for the provision of access (17/6662/RMA).

Dated:

2020

THE COMMON SEAL OF THE MAYOR AND )  
BURGESSES OF THE LONDON BOROUGH )  
OF BARNET was hereunto affixed in the )  
presence of )

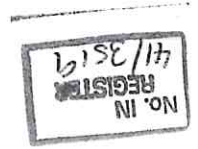

Authorised Signatory

A stylized handwritten signature in black ink.

A handwritten signature in black ink, followed by the name 'A. CHARNOUS' written in a similar style.



**NOTES**

1. THIS DRAWING IS TO BE READ IN CONJUNCTION WITH ALL OTHER RELEVANT DOCUMENTATION. PRINTED DIMENSIONS.
2. DO NOT SCALE FROM THIS DRAWING. USE ONLY PRINTED DIMENSIONS.
3. ALL DIMENSIONS, CHANGES, LEVELS AND COORDINATES ARE IN METRES UNLESS DEFINED OTHERWISE.
4. THIS DRAWING IS TO BE READ IN CONJUNCTION WITH THE PROJECT HEALTH & SAFETY FILE FOR ANY IDENTIFIED CRITICAL ISSUES.
5. EDGE OF PUBLIC HIGHWAY TO BE STOPPED UP BASED ON DRAWING 18/0645/STR-DR-01.0001, PROVIDED BY LB BURNET DATED AUG 2014.

**KEY**

EDGE OF PUBLIC HIGHWAY TO BE STOPPED UP  
(APPROX. AREA = 1756m<sup>2</sup>)  
(APPROX. LENGTH = 114m)

NO. IN REGISTER  
41/35/22



REV.	DATE	DESCRIPTION
PH	08/NOV/19	POST SIGNATURES
P1	08/NOV/19	REVISED FOLLOWING COMMENTARY
P2	18/OCT/19	REVISIONS TO DRAWING CLARIFIED
P3	03/OCT/19	STOPPING UP AREA
NO	18/AUG/19	ORIGINAL ISSUE
DES	08/1/20	

**steer**

Client: BRENT CROSS SOUTH LIMITED PARTNERSHIP  
Project Title: BRENT CROSS SOUTH  
Drawing Title: CLAREMONT WAY HIGHWAY TO BE STOPPED UP (S247)  
Status: WORK IN PROGRESS  
Scale: A1  
Scale: 1:500  
Sheet No: 50  
Rev: P4  
Drawing No: 23624002-STR-HGN-100-DR-01.002

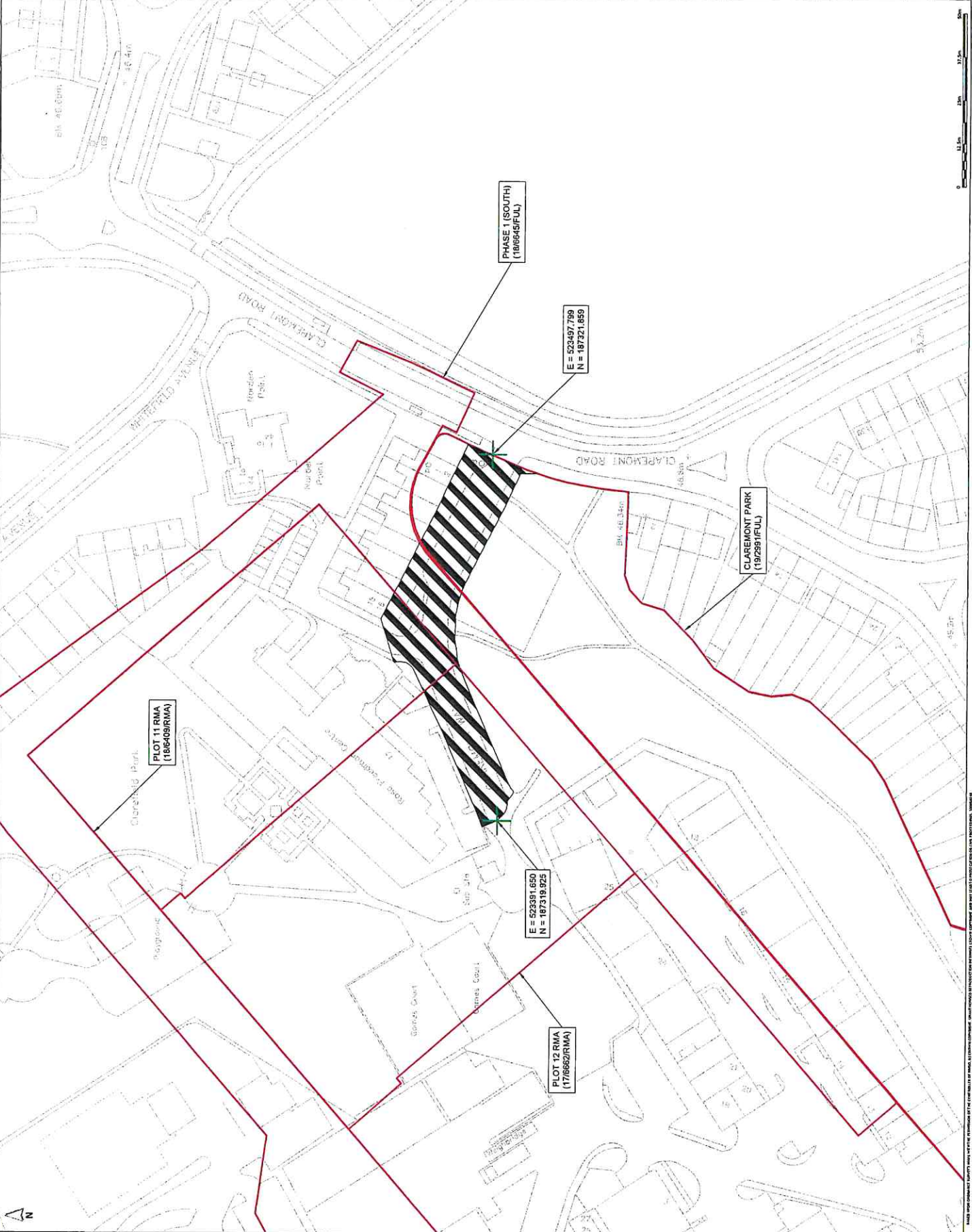

THIS DRAWING IS THE PROPERTY OF STEER CONSULTANTS LTD. IT IS TO BE USED ONLY FOR THE PROJECT AND SITE SPECIFICALLY IDENTIFIED. ANY REUSE OR MODIFICATION WITHOUT THE WRITTEN PERMISSION OF STEER CONSULTANTS LTD IS STRICTLY PROHIBITED. ALL DIMENSIONS AND COORDINATES ARE IN METRES UNLESS OTHERWISE SPECIFIED.

